

STOREYS

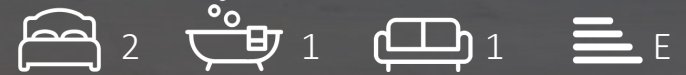

Flat 9, Forest House 2-6 Carnarvon Road, London, E18 2NY
£1,850 Per month



STOREYS

Floor Plan

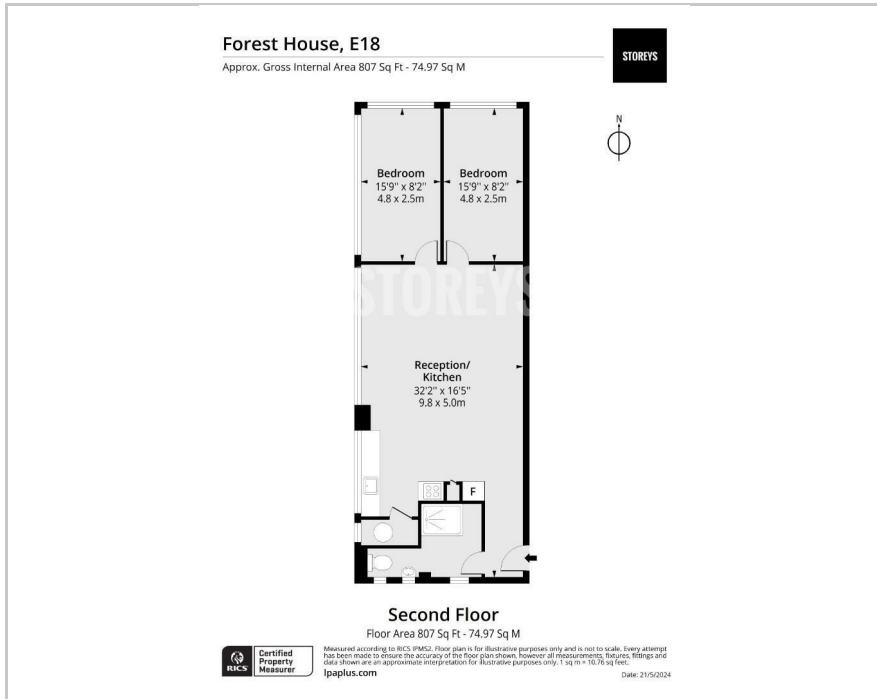

Area Map

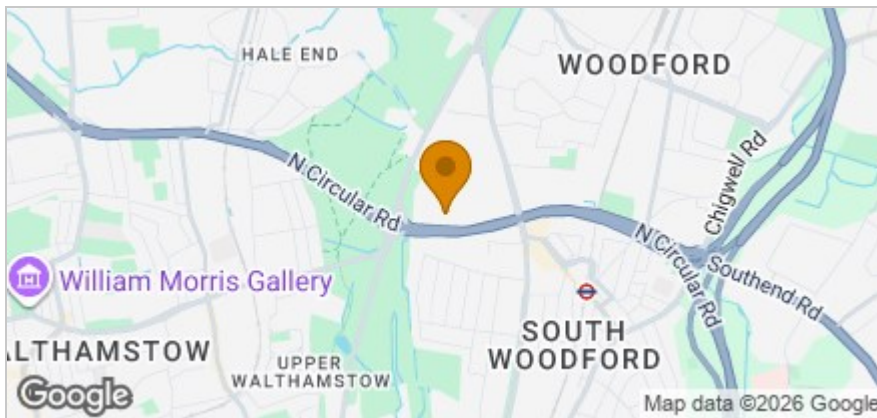

Accommodation

- Characterful Warehouse Conversion
- Newly Refurbished Throughout
- Loft-style apartment
- Two Generous Double Bedrooms
- Bright Open-Plan Living Space
- Contemporary Fitted Kitchen
- Full-Width Industrial-Style Windows
- Stylish Modern Bathroom
- Moments From South Woodford Station (Central Line)
- Walking Distance To George Lane's Cafés, Restaurants & Shops

Viewing

Please contact our Storeys of London Office on 0207-096-0666 if you wish to arrange a viewing appointment for this property or require further information.

Energy Efficiency Graph

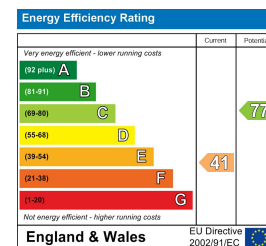

These particulars, whilst believed to be accurate are set out as a general outline only for guidance and do not constitute any part of an offer or contract. Intending purchasers should not rely on them as statements of representation of fact, but must satisfy themselves by inspection or otherwise as to their accuracy. No person in this firm's employment has the authority to make or give any representation or warranty in respect of the property.

77 Containerville 1 Emma Street, Bethnal Green, E2 9FP

Tel: 0207-096-0666 Email: lettings@storeys.co <https://www.storeys.co/>